

ESTACAS	COTAS TERRENO	COTAS PROJETO	ELEMENTOS HORIZONTAIS	ELEMENTOS VERTICAIS
0+0,000	49,912	49,912	R=147,781m Dc=6,137m	i = 0,00% em 0,00m
10+19,367	52,952	52,952		
11+2,435	52,868	52,868	R=17,754m Dc=11,194m	Lc = 65,00m
11+5,000	52,849	52,849		
11	52,759	52,759	Tg=18,216m	
11+12,026	52,717	52,717		
11+15,000	52,665	52,665	R=284,899m Dc=29,839m	
11+17,623	52,646	52,646		
12	52,550	52,550	Tg=13,572m	i = -8,28% em 27,50m
12+3,220	52,523	52,523		
12+5,000	52,222	52,222	R=84,919m Dc=9,749m	
12	51,959	51,959		
13	51,634	51,634	Tg=16,660m	Lc = 25,00m
13+1,436	51,377	51,377		
13+5,000	51,187	51,187	R=70,662m Dc=5,353m	
13	50,855	50,855		
13+15,000	50,782	50,782	Tg=18,035m	i = 12,00% em 7,50m
13+16,355	50,420	50,420		
14	50,451	50,451	R=208,875m Dc=15,932m	Lc = 15,00m
14+5,000	49,353	49,353		
14	49,247	49,247	Tg=9,428m	i = 1,00% em 12,50m
14+11,275	48,862	48,862		
14+15,000	48,525	48,525	R=17,242m Dc=6,328m	Lc = 20,00m
15	48,123	48,123		
15+5,000	47,845	47,845	Tg=13,667m	i = -3,31% em 5,00m
15	47,316	47,316		
16	47,195	47,195		
16+5,000	46,963	46,963		
16	47,009	47,009		
16+11,255	47,169	47,169		
16+13,000	47,388	47,388		
16+16,609	47,748	47,748		
17	48,925	48,925		
17+5,000	49,063	49,063		
17	49,318	49,318		
17+14,644	49,575	49,575		
18	49,624	49,624		
18+2,610	49,624	49,624		
18+5,000	49,594	49,594		
18	49,594	49,594		
18+15,000	49,655	49,655		
18+15,000	49,771	49,771		
19+0,004	49,758	49,758		
19+3,169	49,723	49,723		
19+5,000	49,655	49,655		
19+6,333	49,551	49,551		
19	49,551	49,551		
19+15,000	49,351	49,351		
19+20,000	49,351	49,351		

LEGENDA

- POSTE EXISTENTE
- CADASTRO
- CERCA DE ARAME
- MEIO-FIO 13X15X30X100cm
- CORTE
- ATERRO
- PAVIMENTO PROJETADO EM LAJOTAS SEXTAVADAS
- BORDOS EXISTENTES

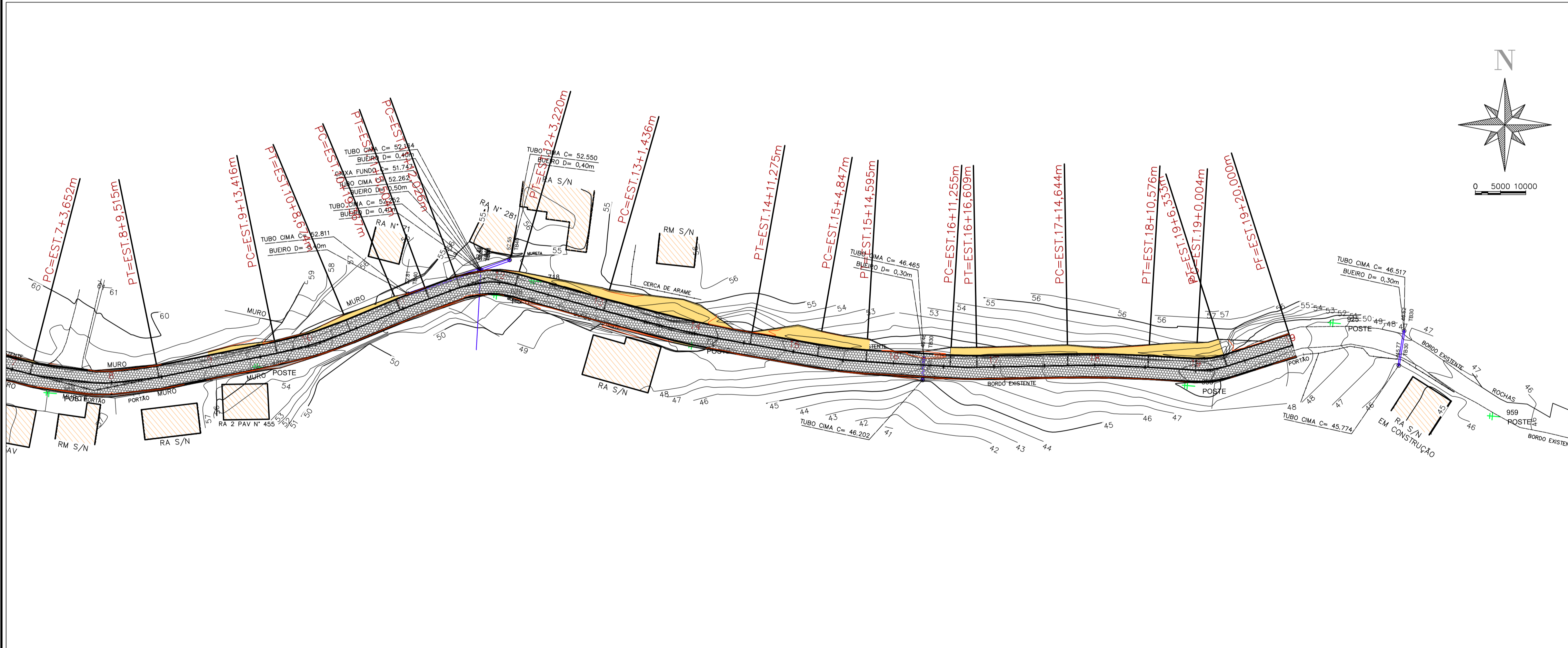

PROJETO DE PAVIMENTAÇÃO

MUNICÍPIO
SANTO AMARO DA IMPERATRIZ – SC

OBRA	CONTEÚDO
SERVIDÃO IMACULADA CONCEIÇÃO	PROJETO DE PAVIMENTAÇÃO EM LAJOTAS SEXTAVADAS PLANTA BAIXA
PROJETO	APROVAÇÃO DA PREFEITURA
CRISTIANE FREITAS Engenheira Civil CREA/SC 109.760-3	

REVISÃO	DATA	PRANCHA
	JUN/20	2/3